

Assembly Instructions for MiMo 1 Drawer Case

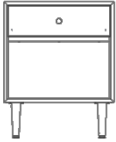

Please identify the listed items before installation.

Components included:

□ Case Leg (4)



Tools required None

Step 1: Install the case legs

Lean the case body on its back on a soft surface (*Figure 1*). Screw each leg into the metal brackets on each corner of the case bottom.

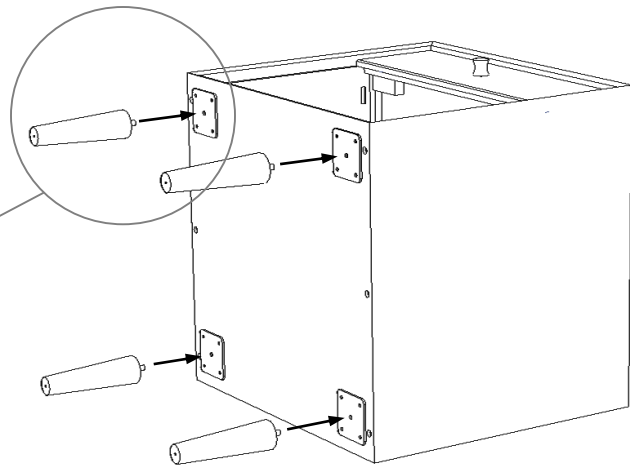
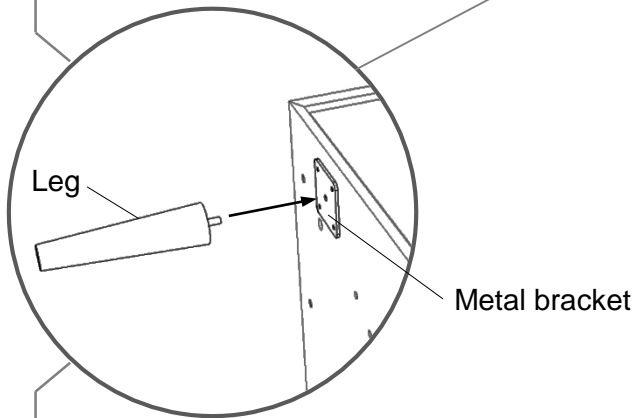

Figure 1. Install the case legs

Step 2: Stand the case upright

To avoid excess pressure on the back legs, when standing up the case, lift the case upright and gently set 4 legs on the floor (*Figure 2*).

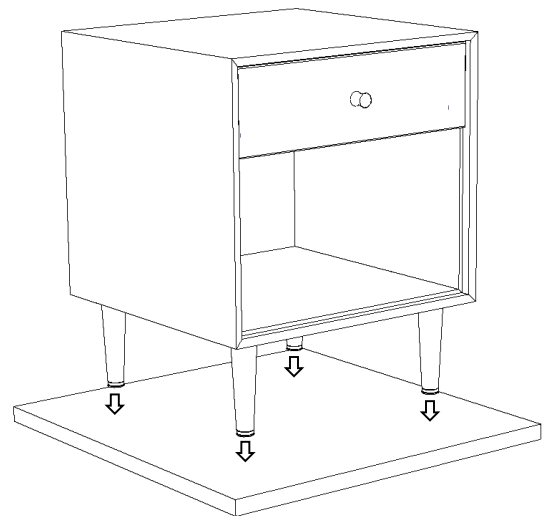

Figure 2. Gently place the case on the floor

Adjust Drawer Slides



Tools required None

How to release the drawer slides

To remove drawers from the slides, press both handles on the front slide clips on the drawer bottom and firmly pull drawer forward (*Figure 1*).

How to reinstall the drawer

Fully extend the drawer slides (from the case) and place drawer box on top of the slides. Pull each slide forward until it locks into both left and right slide clips. You will hear a locking “click” when the slide is locked properly (*Figure 2*). After the drawers are installed, they can be further leveled by sliding the small adjustment knob forward or back. This raises or lowers the drawer box in the case (*Figure 3*).

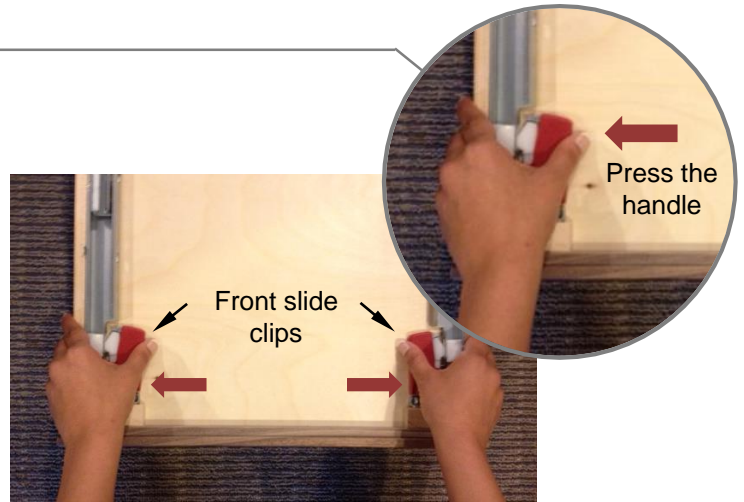

Figure 1. Release the slides

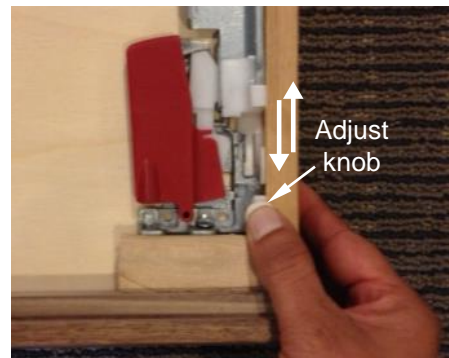

Figure 3. Adjust slides

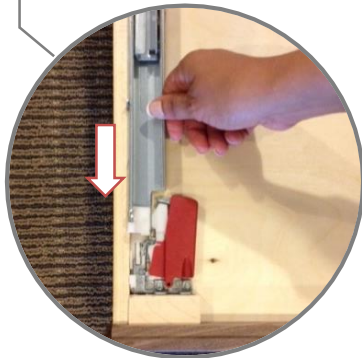

Figure 2. Attach slides

Disabling Soft Close/Self Close Drawer Slide

Tools required Pliers

The soft close/self close function of drawer sides requires some additional pull force to open a drawer for the first several inches. If you find this objectionable, and would like to lessen the amount of pull force needed to open a drawer, the soft close/self close function can be disabled on one side. **Once disabled, it cannot be restored.** If one slide is disabled, the drawer will require less pull force to open. The drawer will still self close.

On the slide you'll find a pin that trips the self close function of the drawer slide (Figure 1).

Twist and remove the pin on **one slide** with a pliers. This will reduce by half the pull force required to open the drawer (Figure 2).

The pin cannot be reattached. This is a permanent change.



Figure 1. Pull out the drawer



Figure 2. Remove the pin



Care Instructions

To care for and preserve the finish on your new Copeland Furniture piece, please keep the following recommendations in mind.

- While our furniture has been finished with a durable top coat, the surface may be sensitive to dents and abrasions during the first 30 days in your home.
- Treat the surface finish gently so it does not dent or chip. Tape or stickers should not be put on the finish.
- For general care use a soft cloth to dust the furniture.
- Use damp cloth with a mild soap to clean-up spills or dirt. Dry the surface thoroughly.
- Please do not use any polishes, waxes or solvents to clean the surface of the furniture. This holds true for new Copeland Furniture pieces as well as items you may already have in your home.
- Please do not place any candles directly on the surface of your furniture. The perfumes and dyes in the candles may penetrate the finish.
- Beds must be disassembled before moving to avoid damage. Never attempt to move the bed while it is assembled.

Special Care Instructions for Cherry Furniture

Furniture crafted from cherry wood darkens with age. This change in color, from a reddish tan to a reddish brown, results from the natural oxidation of the wood when it is exposed to light. Objects left on a piece of cherry furniture for an extended period will retard this oxidation process and when removed, may leave a lighter colored outline of the object on the surface. With continued exposure to light, this color difference will eventually disappear and the wood will reach a mature even tone.

